

**Appendix A: The location and layout
of the AQM station at Cheung Chau**

Pet File by: LVP 2017/14
PATH: G:\PROJECT\8009114\DRAWING\CONTRACT\EP1003.dgn

Project Management Initials: Designer: DNCM Checked: ELIM Approved: BMWL ISO A1 594mm x 841mm

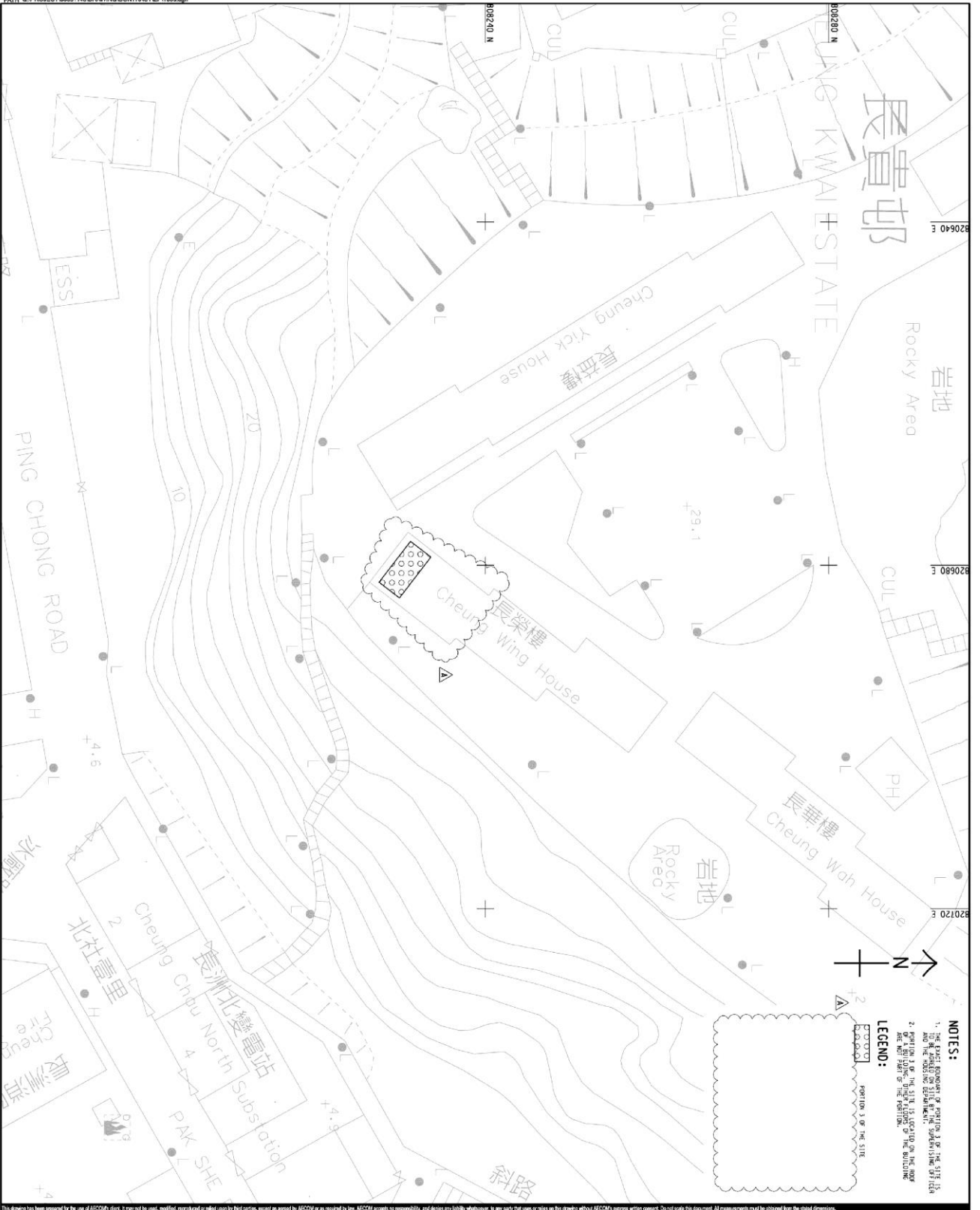

- NOTES:**
1. THE EXIST PROPERTIES OF PORTION 3 OF THE SITE IS TO BE DEMOLISHED AND THE SITE TO BE REDEVELOPED AS A RESIDENTIAL DEVELOPMENT.
 2. THE EXIST PROPERTIES OF PORTION 3 OF THE SITE ARE NOT PART OF THE PORTION.
- LEGEND:**
- PORTION 3 OF THE SITE

This drawing has been prepared for the use of AECOM's client. It may not be used, modified, reproduced or relied upon by third parties, except as agreed by AECOM or as required by law. AECOM accepts no responsibility, and denies any liability whatsoever, to any party that uses or relies on this drawing without AECOM's express written consent. All measurements must be obtained from the stated dimensions.

AECOM

PROJECT
INTERGRATED WASTE
MANAGEMENT
FACILITIES PHASE 1

CLIENT
ENVIRONMENTAL
PROTECTION DEPARTMENT
GOVERNMENT OF THE HKSAR

CONSULTANT
AECOM Asia Company Ltd
www.aecom.com

SUB-CONSULTANTS

NO.	ISSUE/REVISION	DATE	BY	CHECKED	STATUS
1	JAN 17 TENDER ADDENDUM NO.1	ELIM			
2	NOV 16 TENDER	ELIM			
3	NOV 16 REVISION	DNM			

SCALE
A1: 1:200
DIMENSION UNIT
METRES



PROJECT NO. 60239239
CONTRACT NO. EPS/98/12

SHEET TITLE
PORTION 3 OF THE SITE

SHEET NUMBER
60239239/EP1/103A